



LiteWide Node

Individual luminaire controller
via GSM/2G/3G/4G/5G/NB-IoT/LoRa

LiteWide Node is a wireless GSM/NB-IoT control unit mounted on a NEMA socket, Zhaga socket, or wired. It provides dimming functionality for luminaires up to 1000W via different interfaces (DALI, DALI2.0, PWM/1-10V, 0-10V) as well as individual load control (on/off). LiteWide takes advantage of the existing GSM/2G/3G/4G/5G/NB-IoT/LoRa network which makes its deployment quicker and easier.

In addition to dimming, LiteWide nodes provide remote live individual control and diagnostics of luminaires and lighting poles. Luminaire control is available via a connected third party motion sensor or embedded daylight sensor. LiteWide nodes have an integrated GPS/GLONASS module that sends positioning data, corrects internal clock, and embedded accelerometer that measures vibration, acceleration and tilt angle.

Unlike wireless radio UNB control nodes (LiTouch by Sundrax), LiteWide Nodes communicate directly with QULON Server without any intermediate gateways which makes them extremely useful for territories with high density of buildings or mountainous terrain, and for regions where legislation prohibits using radio control.

Key Features

Ultra compact waterproof IP66 case

Versions with open wires, NEMA and Zhaga plug

Withstand voltage up to 305V

Works with luminaires up to 1000W

Embedded daylight sensor

Embedded triac for load switching on/off

Motion sensor input for third party sensors

Input for DALI 2.0 motion sensors and eco sensors of QULON product family

Embedded GPS/GLONASS module

Embedded accelerometer that monitors lighting pole status

Compatible to QULON Eco monitoring station

LEDs showing node status

Variable output interfaces/protocols: DALI/DSI, Modbus RTU/ASCII (as QULON LiteWide), DMX512 (as MONARQ Mini)

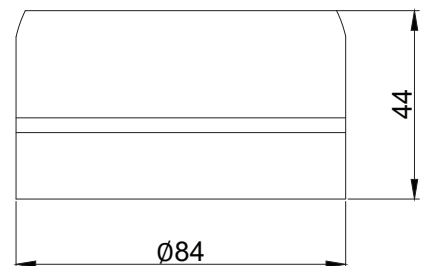

QULON CMS

The QULON CMS is an extremely powerful yet flexible lighting management system that allows remote control of lighting infrastructures of any size and sort: We successfully deployed this system to control street lighting in entire cities, highways and tunnels but also industrial and warehouse lighting, airports, livestock farms, greenhouses, parking lots, train stations, leisure centres, parks and many more; It is composed of two different interfaces, a PC software featuring the most advanced programming functions and a web version to monitor and control your lighting assets on the go, together they offer a complete suite of tools for any kind of project and any kind of user.

LiteWide Node

Individual luminaire controller
via GSM/2G/3G/4G/5G/NB-IoT/LoRa

Version: 2.0
2 Jun 2021

Technical Specifications

Mechanical

Housing: Solid case

Material: Plastic

Dimensions, mm: 84(D) x 44(H) x 84(W)

Mass: 0.2 kg

Mounting: Luminaire case, pillar, etc

Power & Electrical

Input Voltage: ~100-270 VAC, 50/60 Hz or 12-30V

Input Power (max): 5 W

Max load Power: 1000 W

Environmental

Operating Temperature: -40...+70°C

Storage Temperature: -50...+80°C

Operating Relative Humidity (max): 100%

IP Rating: IP66

Certification: CE, RoHS

Warranty: 36 Month (Return to base)

Inputs/ Outputs

Connectors: Wires, NEMA C136.41 plug,
Zhaga book 18 connector

Sensors: Embedded daylight sensor,
Motion sensor input, Accelerometer

Interfaces and Protocols

Control output interface/protocols: DALI

Navigation: GPS/GLONASS

Radio Channel: GSM 850/900/1800/1900;
WCDMA 900/2100 (optional)

Transmit Power Range(s):

Class 4 (+33dBm \pm 2dB) for EGSM 850/900

Class 1 (+30dBm \pm 2dB) for GSM 1800/1900

Configuration/ Indication

Setup: Remote via QULON software

Indication: LED

Package Contents

LiteWide Node

Product Line

Name	Modification	Product code
LiteWide Node	2G, NEMA connector	QUL-LW-N-2GDAL
	2G, wire (1.5m)	QUL-LW-W-2GDAL
	4G, NEMA connector	QUL-LW-N-4GDAL
	4G, wire (1.5m)	QUL-LW-W-4GDAL
	NB-IoT, NEMA connector	QUL-LW-N-NBDAL
	NB-IoT, wire (1.5m)	QUL-LW-W-NBDAL
	2G, Zhaga connector	QUL-LW-Z-2GDAL
	4G, Zhaga connector	QUL-LW-Z-4GDAL
	NB-IoT, Zhaga connector	QUL-LW-Z-NBDAL
	LoRa, NEMA connector	QUL-LW-N-LODAL
	LoRa, wire (1.5m)	QUL-LW-W-LODAL
	LoRa, Zhaga connector	QUL-LW-Z-LODAL
	5G, NEMA connector	QUL-LW-N-5GDAL
	5G, wire (1.5m)	QUL-LW-W-5GDAL

LiteWide Node

Individual luminaire controller
via GSM/2G/3G/4G/5G/NB-IoT/LoRa

Version: 2.0
2 Jun 2021

Connection Scheme

Wire connection

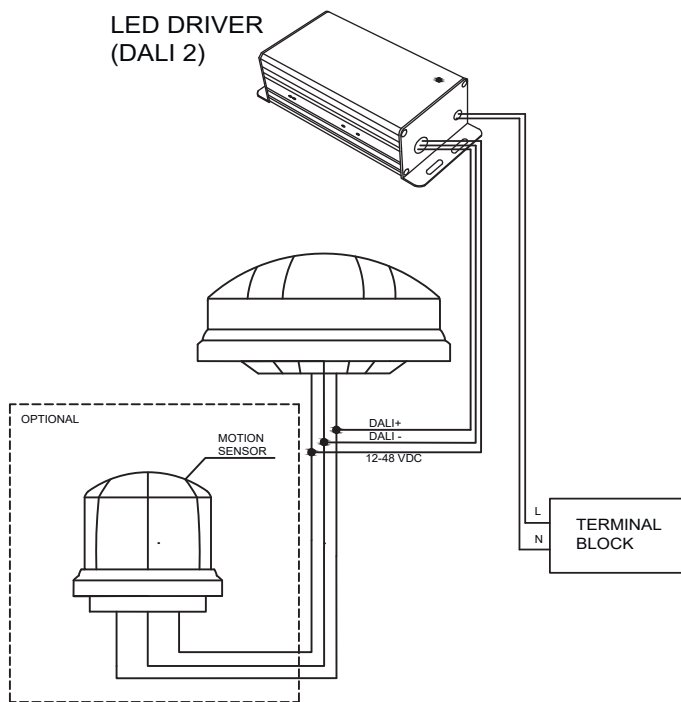

NEMA connection

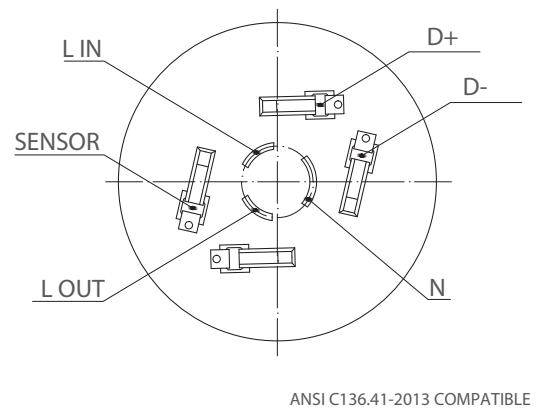

Zhaga connection

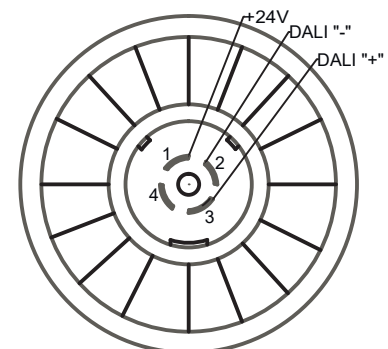

Disclaimer

To the best of our knowledge, the technical data contained herein is true and accurate at the date of issuance and is subject to change without prior notice. No liability accepted for errors or omissions. Always make sure to use the most recent release and contact Sundrax Electronics to verify correctness before placing your order.

Accessories

Name

- 5-pin NEMA connection socket
- 7-pin NEMA connection socket
- 4-pin Zhaga connection socket
- Motion sensor, microwave, 360°, with luminance sensor
- Motion sensor, infra red, 180°, with luminance sensor
- Street light arm mounting kit for cylinder shaped devices
- Pole/wall mounting kit for cylinder shaped devices
- Power cabinet mounting kit for cylinder shaped devices
- Protective cap for cylinder shaped devices

Product code

- ACC-CON-NEMA5
- ACC-CON-NEMA7
- ACC-CON-ZHAGA4
- ACC-OP-031835
- ACC-OP-031839
- ACC-MK-CB-LBRA
- ACC-MK-CB-LP/W
- ACC-MK-CB-ELCAB
- ACC-PE-CL-LP/W